



**CARVER ROUTE 58 TRAFFIC DETOUR
FOR MILLING AND HOT MIX ASPHALT PAVING
ZONE 1 & ZONE 2 NORTHBOUND DETOUR**

VARIABLE MESSAGE BOARD (VMB):
"ROUTE 58 "MILLING" OR "PAVING"
DATE TBD
7AM TO 5PM
FOLLOW DETOUR ROUTE"

- SIGN POSITION AND LOCATION 
- VMB POSITION AND LOCATION 
- POLICE OFFICER LOCATION (PO) 

- DETOUR ROUTE ZONE 1 
- DETOUR ROUTE ZONE 2 
- WORK ZONE 

NOTE: POLICE OFFICERS PLACED AT START OF DETOUR, CRITICAL TURNS, AND WITH MILLING/PAVING OPERATION

VMB LOCATION
"ROUTE 28"
"MILLING, PAVING"
DATE TBD
7AM TO 5PM

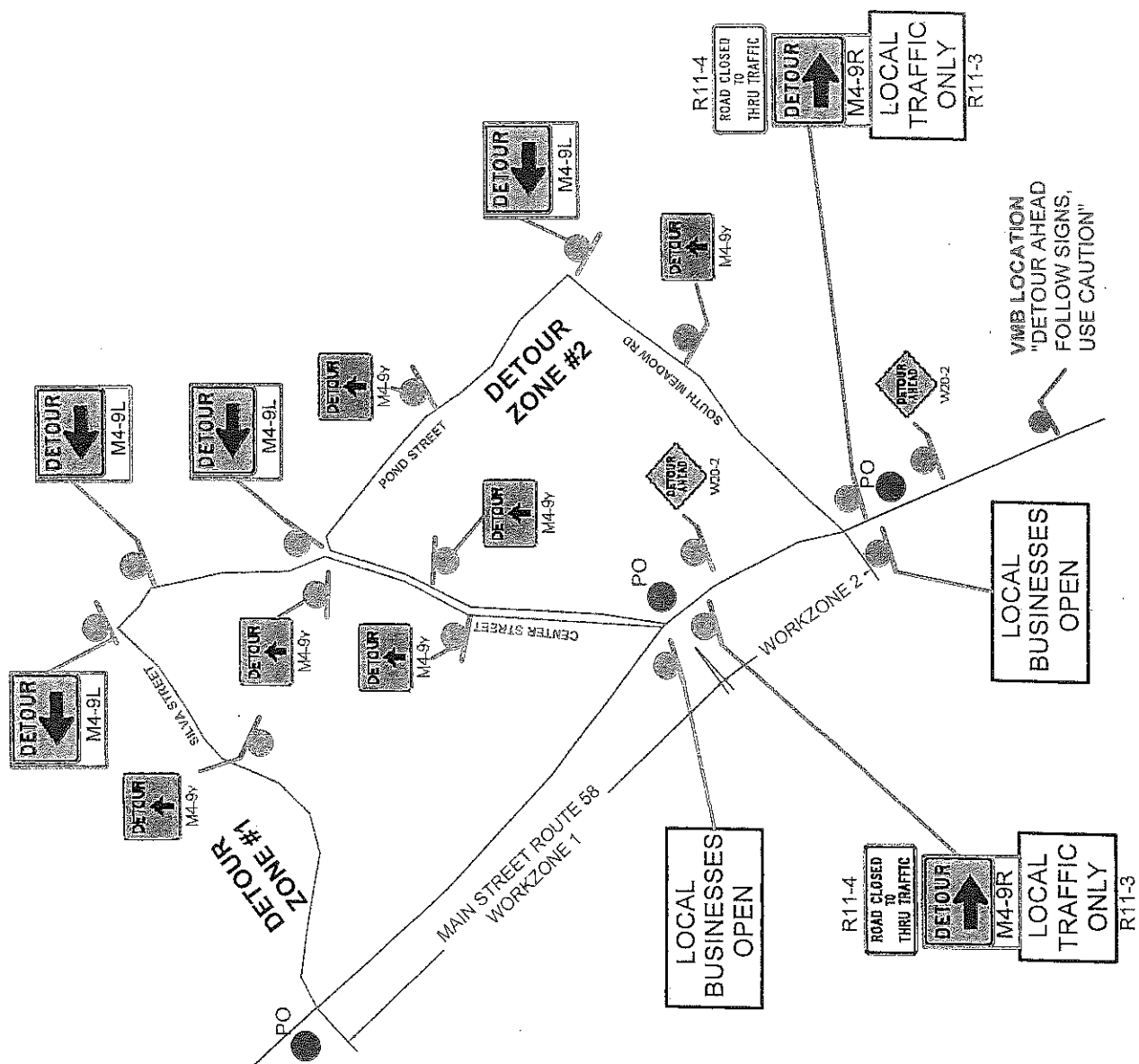

TO SCALE (SCALE UNKNOWN)